

# Instruction Manual & Parts Diagram

## Mini Air Compressor Kit

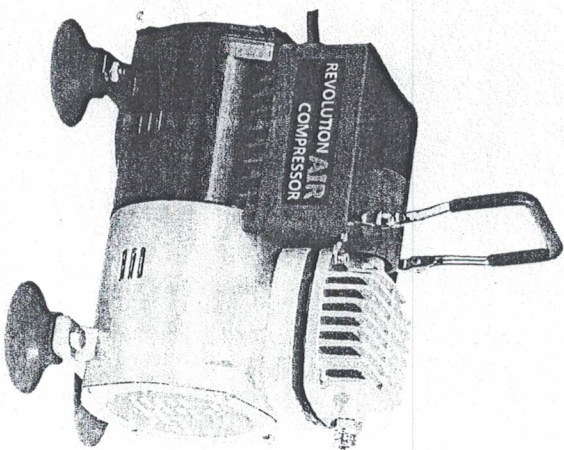

**Model: BASSOTTO**

Purchase Date: \_\_\_\_\_ Purchased Quantity: \_\_\_\_\_

Seller's Store: \_\_\_\_\_

Address: \_\_\_\_\_

Tel. No.: \_\_\_\_\_

Fax No.: \_\_\_\_\_

E-Mail: \_\_\_\_\_

C666B NEUV2011.00

Please read and save these instructions. Read carefully before attempting to assemble, install, operate or maintain the product described.

Protect yourself and others by observing all safety information. Failure to comply with instructions could result in personal injury and/or property damage! Retain instructions for future reference.



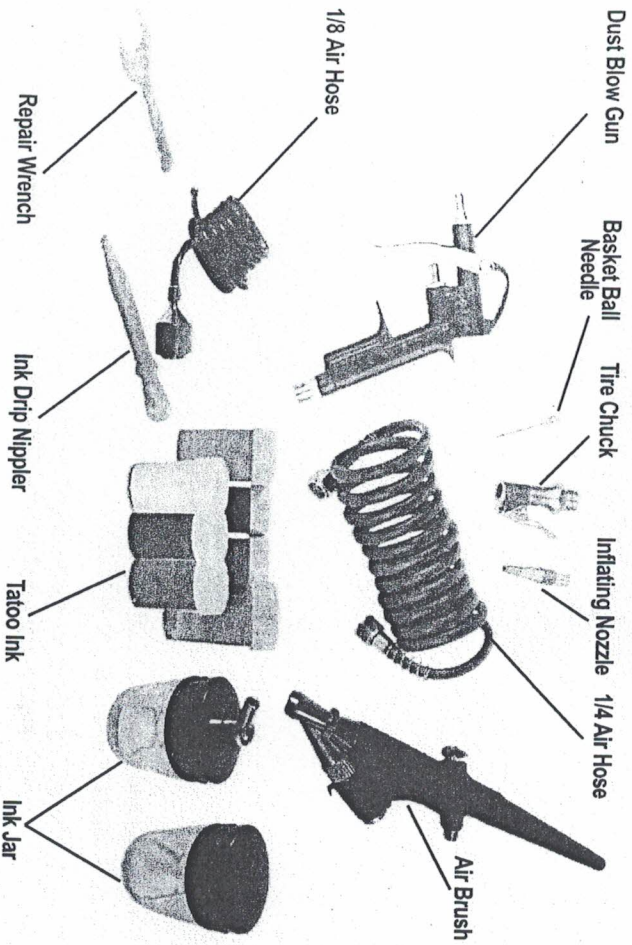
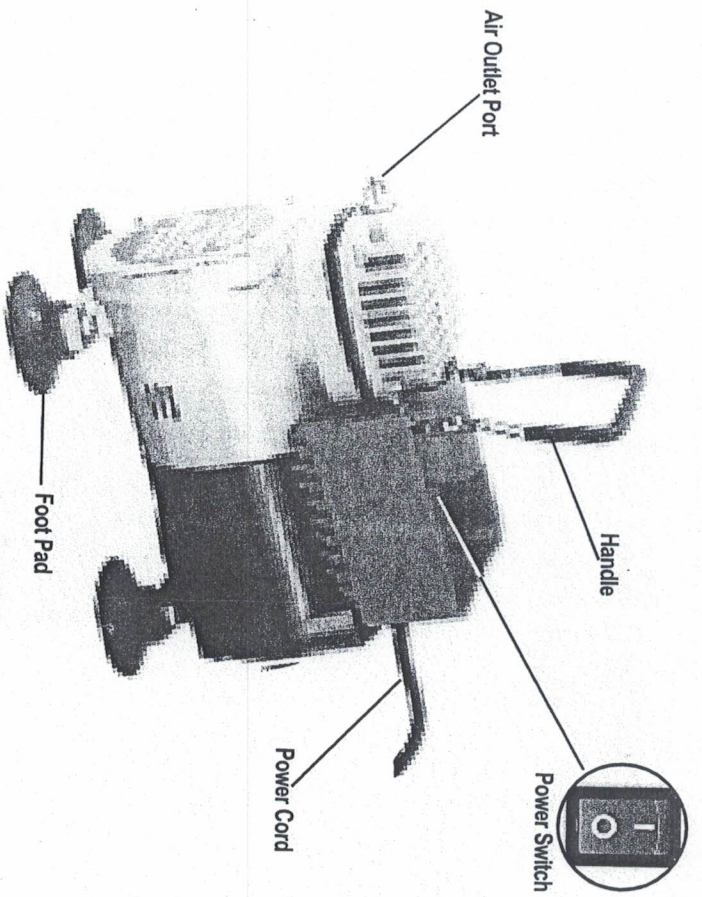

## BEFORE YOU START

### Description

Thank you for purchasing this oil-free compressor. Portable oil-free air compressors are for home and workshop use. Cleaning or replacement of the inlet filter on all models and draining moisture from the air receivers are required maintenance.

**▲ WARNING** Do not operate unit if damaged during shipping, handling or use. Damage may result in bursting and cause injury or property damage.

## GENERAL SAFETY INSTRUCTIONS

### Overview of Safety Warning System and Your Responsibilities

**READ THIS MANUAL BEFORE USING THIS PRODUCT. FAILURE TO FOLLOW THE INSTRUCTIONS AND SAFETY PRECAUTIONS IN THIS MANUAL CAN RESULT IN SERIOUS INJURY OR DEATH. KEEP THIS MANUAL FOR FUTURE REFERENCE.**

Your safety and the safety of others depend on you thoroughly reading and understanding this manual. If you have questions or do not understand the information presented in this manual, please contact your local dealer.

Most tool-related incidents are caused by failure to observe basic safety rules or precautions. You must be alert to potential hazards. You must have the necessary training, skills and tools to perform these functions. Manufacturer cannot anticipate every possible circumstance that might involve a potential hazard. Therefore, the warnings in this manual are not all inclusive. If a tool, procedure, work method or operating technique that is not specifically recommended by the manufacturer is used, you must satisfy yourself that it is safe for you and for others. You should also ensure that the product will not be damaged or be made unsafe by the operation, lubrication, maintenance or repair procedures that you choose.

### Safety Guidelines

This manual contains information that is very important to know and understand. This information is provided for **SAFETY** and to **PREVENT EQUIPMENT PROBLEMS**. To help recognize this information, observe the following symbols:

#### ▲ DANGER

Danger indicates an imminently hazardous situation which, if not avoided, **WILL** result in death or serious injury.

#### ▲ WARNING

Warning indicates a potentially hazardous situation which, if not avoided, **COULD** result in death or serious injury.

#### ▲ CAUTION

Caution indicates a potentially hazardous situation which, if not avoided, **MAY** result in minor or moderate injury.

#### NOTICE

Notice indicates important information, that if not followed, may cause damage to equipment.

**IMPORTANT or NOTE:** Information that requires special attention.

### Safety Symbols

The following Safety Symbols appear throughout this manual to alert you to important safety hazards and precautions.



**▲ WARNING** This product can expose you to chemicals including lead, which are known to cause cancer and birth defects or other reproductive harm.

**▲ WARNING** You can create dust when you cut, sand, drill or grind materials such as wood, paint, metal, concrete, cement, or other masonry. This dust often contains chemicals known to cause cancer, and birth defects, or other reproductive harm. Wear protective gear.



**⚠ WARNING**

CONTAINS LEAD. MAY BE HARMFUL IF EATEN OR CHEWED.

**⚠ DANGER**

**BREATHABLE AIR WARNING**

This compressor/pump is not equipped and should not be used "as is" to supply breathing quality air. For any application of air for human consumption, the air compressor/pump will need to be fitted with suitable in-line safety and alarm equipment.

**DISCLAIMER OF WARRANTIES**

In the event the compressor is used for the purpose of breathing air application and proper in-line safety and alarm equipment is not simultaneously used, existing warranties shall be voided.



**Important Safety Information**

Please read and save these instructions. Read carefully before attempting to assemble, install, operate or maintain the product described. Protect yourself and others by observing all safety information. Failure to comply with instructions could result in personal injury and/or property damage! Retain instructions for future reference

This manual contains important safety, operational and maintenance information. If you have any questions, please contact your local dealer for assistance.

Since the air compressor and other components used (material pump, spray guns filters, lubricators, hoses, etc.), make up a high pressure pumping system, the following safety precautions must be observed at all times:

1. Read all manuals included with this product carefully. Be thoroughly familiar with the controls and the proper use of the equipment.
2. Follow all local electrical and safety code.
3. Only persons well acquainted with these rules of safe operation should be allowed to use the compressor.
4. Keep visitors away and keep out of reach of children.



5. Wear safety glasses and use hearing protection when operating the unit.
6. Do not stand on or use the unit as a handhold.
7. Before each use, inspect compressed air system and electrical components for signs of damage, deterioration, weakness or leakage. Repair or replace defective items before using.



**⚠ WARNING** Motors, electrical equipment and controls can cause electrical arcs that will ignite a flammable gas or vapor. Never operate or repair in or near a flammable gas or vapor. Never store flammable liquids or gases in the vicinity of the compressor.

**⚠ WARNING** WARNING: Do not operate with guard removed.



**⚠ WARNING** WARNING: Risk of electric shock. Use indoors only. Disconnect all connections before servicing

8. Do not wear loose clothing or jewelry that will get caught in the moving parts of the unit.

**⚠ CAUTION** Compressor parts may be hot even if the unit is stopped.

9. Keep fingers away from a running compressor; fast moving and hot parts will cause injury and/or burns.

10. If the equipment should start to vibrate abnormally, STOP the engine/motor and check immediately for the cause. Vibration is generally a warning of trouble.

11. To reduce fire hazard, keep engine/motor exterior free of oil/solvent or excessive grease.

**⚠ WARNING** A safety relief valve with a setting no higher than the maximum allowable working pressure (MAWP) MUST be installed in the tank for this compressor. The safety valve must have sufficient flow and pressure ratings to protect the pressurized components from bursting

**⚠ CAUTION** See compressor specification deal for maximum operating pressure. Do not operate with pressure switch or pilot valves set higher than the maximum operating pressure.

12. Never attempt to adjust the safety valve. Keep safety valve free from paint and other accumulations.



**⚠ WARNING** ALWAYS use quality pipe for compressed air.

**⚠ DANGER** WARNING: Risk of bursting if air tank develops a leak, replace the air tank immediately. Never repair, weld, or modify the air tank or attachments. Never make adjustments to the factory set pressures. Never exceed manufacturer's maximum allowable pressure rating of attachments.

13. Tanks rust from moisture build-up, which weakens the tank. Make sure to drain tank regularly and inspect periodically for unsafe conditions such as rust formation and corrosion. 15. Fast moving air will stir up dust and debris which may be harmful. Release air slowly when draining moisture or depressurizing the compressor system.

**⚠ WARNING** WARNING: Serious injury or death could occur from inhaling compressed air. Never inhale air from the air compressor either directly or from a breathing device connected to the air compressor. The air stream may contain carbon monoxide, toxic vapors or solid particles.

**⚠ NOT spray flammable materials in vicinity of open flame or near ignition sources including the compressor unit**



**⚠ WARNING** WARNING: Risk of fire and explosion. When a combustible liquid is sprayed there can be danger of fire or explosion, especially in a closed area. Keep the compressor / motor at least 6 meters (18 feet) away from explosive vapors.

14. DO NOT spray flammable materials in vicinity of open flame or near ignition sources including the compressor unit. Keep away from heat, sparks and flame.

15. DO NOT smoke. Extinguish all flames and pilot lights and turn off stoves, heater, electric motors and other sources of ignition during use and until all vapors are gone.

16. Prevent build-up of vapors by opening all windows and doors to achieve cross-ventilation. Use only with adequate ventilation.

17. Do not breathe dust, vapors, or spray mist. Ensure fresh air entry during application and drying. If you experience eye watering, headache or dizziness, wear respiratory protection (NIOSH approved or equivalent) or leave the area.

18. Follow OSHA and CSA safety regulations for personal protective equipment. Typical equipment may include safety glasses, respirator, and / or work gloves and is dependent upon the application type, amount of use and work space.



**COMPRESSOR PARTS DIAGRAM**

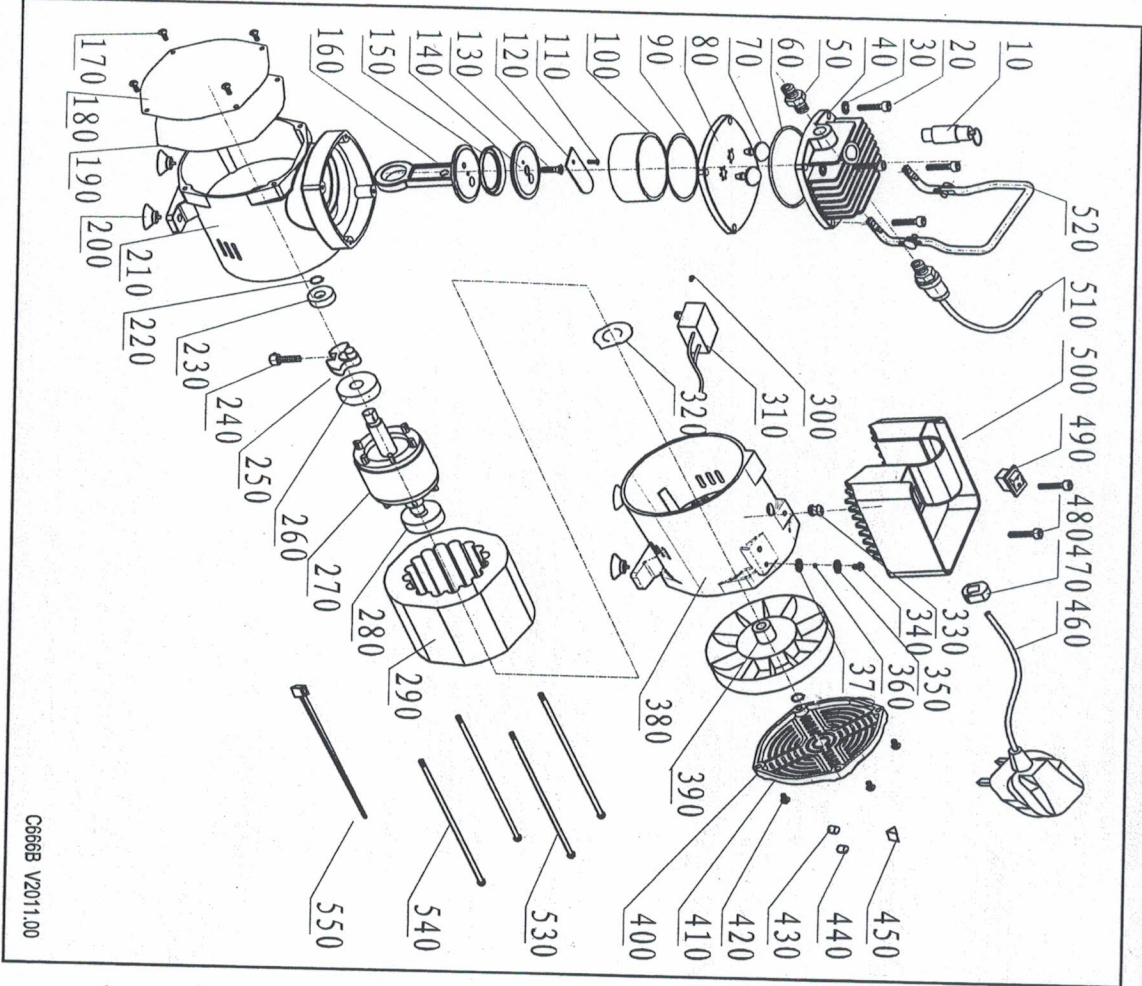

**Note:**

All parts listed herein do not mean in any way that they all available individually. Some parts may be only available in assembly. For after-service parts availability, please contact your local distributor.

For information regarding the operation or repair of this product, please contact your local distributor.

C666B V2011.00

**COMPRESSOR PART LIST**

Posl. No.	Part No.	Description	Qty
10	CAXD2-III-2.5	Safety Valve	1
20	S0300022	Hex Bolt M4*25	4
30	S0400001	Plain Washer	2
40	C66601	Cylinder Cap	1
50	C66602	Air Outlet Fitting	1
60	S0800182	O-Ring 62*2.6	1
70	C66604	Air Outlet Valve	2
80	C66603	Valve Plate	1
90	S0800172	O-Ring 50*2.5	1
100	C66606	Cylinder	1
110	S2300013	Plus Hd. Screw Bolt M3*4	1
120	C66610	Air Inlet Valve	1
130	S2900002	Plus Hd. Screw Bolt M4*8	1
140	C66607	Piston Cap	1
150	C66609	Piston Ring	1
160	C66608	Piston	1
170	S2300045	Plus Hd. Screw Bolt M4*8	4
180	C66622	Front Housing Cap	1
190	C66623	Front Housing Cap Gasket	1
200	C66621	Foot Pad	1
210	C66605	Housing Front	1
220	S2100007	Loop Spring Retainer D7	1
230	S0900015	Bearing 608ZZ	1
240	S0300021	Hex Bolt M5*16	1
250	C66611	Crank	1
260	S0900025	Bearing 6200ZZ	1
270	C66612	Rotor	1
280	S0900025	Bearing 6200ZZ	1

Posl. No.	Part No.	Description	Qty
290	C66613	Stator	1
300	S2900002	Plus Hd. Screw Bolt M4*8	1
310	C666B05	Capacitor	1
320	S3400001	Wave Washer d=30	1
330	C66624	Rubber Bushing	1
340	S2300045	Plus Hd. Screw Bolt M4*8	1
350	S0400001	Plain Washer d=4	1
360	S0500006	Vibrate Wahser d=4	1
370	S3300002	Toothed Washer d=4	1
380	C666B04	Housing Rear	1
390	C66626	Motor Fan Assembly	1
400	S2100003	Loop Spring Retainer D10	1
410	C666B01	Rear Housing Cap	1
420	S2300002	Plus Hd. Screw Bolt M4*14	4
430	00A0005	Shrink Tube D3.5	4
440	00A0003	Shrink Tube D6	2
450	S1900002	U Type Wire Terminal	1
460	C66619	Power Cord	1
470	C66620	Power Cord Boot	1
480	S0300023	Hex Bolt M4*14	2
490	C66618	Power Switch	1
500	C666B03	Top Tray	1
510	C66615	Pressure Switch	1
520	C666B02	Handle	1
530	S2300065	Plus Hd. Screw Bolt M4*110	1
540	S2300012	Plus Hd. Screw Bolt M4*115	3
550	S6400002	Nylon Tie	1



## SETUP / ASSEMBLY

### **⚠ WARNING**

Read the **ENTIRE IMPORTANT SAFETY INFORMATION** section at the beginning of this manual including all text under subheadings therein before set up or use of this product. Inspect tool before use, looking for damaged, loose, and missing parts. If any problems are found, do not use tool until repaired.

Inspect tool before use, looking for damaged, loose, and missing parts. If any problems are found, do not use tool until repaired.

1. Connect one end of the air hose to the Air Outlet (38).
2. Connect other end of air hose to the Air Brush (27).
3. Inspect the air connections for leaks. Repair any leaks found.



Read the **ENTIRE IMPORTANT SAFETY INFORMATION** section at the beginning of this manual including all text under subheadings therein before set up or use of this product. Inspect tool before use, looking for damaged, loose, and missing parts. If any problems are found, do not use tool until repaired.

### **Work Piece and Work Area Set Up**

1. Designate a work area that is clean and well-lit. The work area must not allow access by children or pets to prevent distraction and injury.
2. Route the air hose along a safe route to reach the work area without creating a tripping hazard or exposing the air hose to possible damage. The air hose must be long enough to reach the work area with enough extra length to allow free movement while working.
3. Secure loose workpieces using a vise or clamps (not included) to prevent movement while working.
4. There must not be hazardous objects (utility lines or foreign objects) nearby that present a hazard while working.

### **General Operating Instructions**

1. Choose a 120V power supply and plug in Air Compressor.
2. Set the Pressure Gauge to desired air pressure (maximum 58 PSI).
3. Fill the 22cc Glass Jar (31A) after thinning your paint properly.

### **NOTICE** Use the proper solvent for thinning.

Use lacquer thinner for all lacquers, paint thinner for oil based paints, and water for all latex based paints.

4. Hold the Air Brush Housing lightly in your hand and push the tapered fitting on the lid of the Glass Jar Assembly into the base of the Air Brush Housing. It is held in place with friction and not threading.
5. Turn on the Power Switch and the Air Compressor will start and work continuously until it reaches its maximum preset pressure which will be approximately 55 PSI at which time it will automatically shut down. It will re-start when the pressure drops to approximately 42 PSI.
6. By pressing the Finger Lever air will emerge from the Nozzle. Draw back slowly/gently on the Finger Lever and the fluid will atomize. Continue to move the Finger Lever to achieve the air volume you need for your spray technique.
7. Continue to adjust the spray volume by using the Finger Lever, moving it front to back. When you have the correct spray volume, you may fix the position using the Adjustment Screw.

8. The size of the spray pattern will be in accordance with the distance between the work surface and the Nozzle of the Air Brush. For extra-fine spray, remove the Protective Cap and hold the Air Brush nearer the work surface.
9. When you are finished painting, gently release pressure on Finger Lever.

### **NOTICE**

If while using this Air Brush and fluid blocks the Nozzle from working, move Needle Chucking Guide back and forth. If this does not clear the Nozzle, try loosening the Needle Adjustment Screw. This will allow a longer movement for the Needle and allow the blocked fluid to escape clearing the Nozzle.

10. After flushing the Air Brush unit completely with the proper solvent: Lacquer thinner if you used a lacquer paint, water if you used a latex based paint and paint thinner for all oil based enamels, spray remaining solvent through the Nozzle until clear solvent sprays from end of Airbrush tip.

### **NOTICE**

ALL paints used with this Air Brush are fast drying by design and can seriously damage your tool if they are NOT flushed immediately.

11. Bleed excess air from hose and drain water out of the Water Drain Valve on the Air Compressor only after turning OFF Power Switch and unplugging the Compressor from the power supply, or from your extension cord.

### **MAINTENANCE INSTRUCTION**

### **⚠ WARNING**

TO PREVENT SERIOUS INJURY FROM ACCIDENTAL OPERATION, make sure Power Switch of tool is in its "Off" position and that the tool is unplugged from its electrical outlet before any maintenance or repairs are done.

1. **BEFORE EACH USE**, inspect the general condition of the tool. Check for loose screws, misalignment or binding of moving parts, cracked or broken parts, damaged electrical wiring, and any other condition that may affect its safe operation. If abnormal noise or vibration occurs, have the problem corrected before further use. Do not use damaged equipment.
2. **AFTER EACH USE**, wipe off with a clean, moist cloth. Also completely flush, clean and wipe down Air brush and all that were used during operation.
3. **AFTER EVERY 500 HOURS OF REGULAR USE**, replace Compression Ring and Inlet and Outlet Valves. Please note: This work should only be done by a qualified service technician.

### **SPECIFICATIONS**

Motor Power	300 W	Current	2.0 A
Air Delivery	40 L/Min. (Appr. 1.141 CFM)	Maximum Pressure	3.2 Bar (Appr. 42 PSI)
Power Supply	220V - 240V / 50Hz	Motor Speed	1440 RPM



